

## INFORMATION FOR PARENTS AND ADULTS

Dear Parents,

With this kit, you will be helping your child experiment with sunshine slime. We are asking you to read these instructions together with your child, follow them and keep them for reference. Only carry out the experiments listed in the instructions. Do not allow the slime powder and the finished slime to come into contact with the eyes or mouth. Please remind your child to wash his or her hands thoroughly after the experiments and after handling the slime. This set is for use only by children over 6 years. For use under adult supervision. Therefore store it out of reach of children under 6 years old and animals. This includes the slime powder, the finished slime, and the materials in the set.

Look for a good place to do the experiments. The area surrounding the experiment should be kept clear of any obstructions and away from the storage of food. Use a solid table with a top that can easily be cleaned. The working area should be cleaned up immediately after carrying out the activity. Also clean all equipment (e.g., the stirring tool) after use and thoroughly wash your hands. The slime powder should be used up (completely) during the course of the experiment. Open the packet of slime powder with scissors — never with your teeth. While experimenting, please be careful not to create dust of the powder. Do not eat or drink in the experimental area and while doing the experiments. The slime may cause stains that can't be washed out of clothing. Therefore wear suitable clothes that can get stained and keep the materials away from table clothes, curtains, and carpets. Store the finished slime in the test tube to prevent it from drying out and to prevent it from sticking on the surface. Dispose off all materials in this kit in the household trash, as well as the slime when it gets dirty, liquefies, or dries out.

We hope you and your child have a lot of fun with the sunshine slime!

## SAFETY INFORMATION

### **WARNING!**

Not suitable for children under 3 years. Choking hazard — small parts may be swallowed or inhaled. Keep packaging and instructions, as they contain important information.

### **Instructions for handling the powder**

**Sunshine slime powder, 6.5-7.5 g (0.23-0.27 oz.)**

Main ingredients: Locust bean gum, guar gum, silica, color pigment

Do not ingest. Avoid breathing dust. Only perform experiments that are described in this instruction manual. Do not get in eyes, into the mouth or on clothing. Wash hands thoroughly after handling.

In case of eye contact: Wash out eye with

plenty of water, holding eye open if necessary. If swallowed: Wash out mouth with water, drink some fresh water. Do not induce vomiting. In case of doubt, seek medical advice without delay. Take the slime or powder and its packet / this manual with you. Store locked up. Keep out of reach of small children and animals.

Use the materials carefully, as they may stick to or stain fabric, wood, carpet, or other materials. Clean with water. Dispose of the empty bag and other remainders in the trash. As we have omitted hazardous substances from this slime, it will disintegrate after a few days; the mixture becomes watery. Please dispose of it in the household trash using paper towels.

3RD EDITION © 2022 THAMES & KOSMOS, LLC, 89 SHIP ST., PROVIDENCE, RI, 02903, USA

1-800-587-2872 [WWW.THAMESANDKOSMOS.COM](http://WWW.THAMESANDKOSMOS.COM)  
© 2018 FRANCKH-KOSMOS VERLAGS-GMBH & CO. KG,  
PFIZERSTR. 5-7, 70184 STUTTGART, GERMANY  
+49 (0) 711 2191-0 [WWW.KOSMOS.DE](http://WWW.KOSMOS.DE)

® THAMES & KOSMOS IS A REGISTERED TRADEMARK OF THAMES & KOSMOS, LLC.

PROTECTED BY LAW. ALL RIGHTS RESERVED. WE RESERVE THE RIGHT TO MAKE TECHNICAL CHANGES.

THIS WORK, INCLUDING ALL ITS PARTS, IS COPYRIGHT PROTECTED. ANY USE OUTSIDE THE SPECIFIC LIMITS OF THE COPYRIGHT LAW WITHOUT THE CONSENT OF THE

PUBLISHER IS PROHIBITED AND PUNISHABLE BY LAW. THIS APPLIES SPECIFICALLY TO REPRODUCTIONS, TRANSLATIONS, MICROFILMING, AND STORAGE AND PROCESSING IN ELECTRONIC SYSTEMS AND NETWORKS. WE DO NOT GUARANTEE THAT ALL MATERIAL IN THIS WORK IS FREE FROM COPYRIGHT OR OTHER PROTECTION.

ILLUSTRATIONS/PHOTOS: THAMES & KOSMOS, LLC;  
KOSMOS-ARCHIV; JOERGSAM © WIKI-  
PEDIA.DE, CC BY-SA 4.0

PRINTED IN TAIWAN / IMPRIMÉ EN TAÏWAN

## 1. SETTING UP THE OOZE TUBE

### CONTENTS

Test tube, lid, packet of slime powder, cardboard strip

### YOU WILL ALSO NEED

*Permanent marker, water, scissors, paper towel, stirring tool*

### HERE'S HOW

1. Remove the contents from the test tube.
2. Use the cardboard strip to make a test tube holder by rolling it into a circular tube and fitting it into the cap. Place the test tube into the holder.

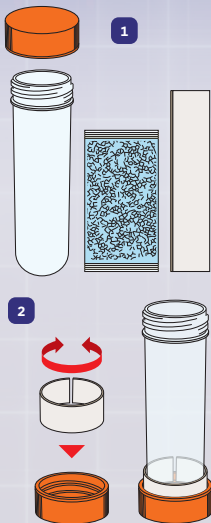

## 2. MIXING THE SLIME

3. Fill the test tube with 75 ml of water. To measure this, use the test tube guide printed here to make a mark on the test tube. Fill the test tube up to the line with water. (You can also just eyeball it.)

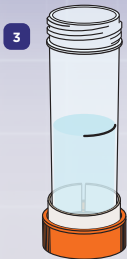

4. Open the packet of powder using a pair of scissors. Do not use your teeth.



**CAUTION!** Be careful not to get the powder in your mouth or eyes!

9 cm  
(75 ml)

TEST TUBE FILLING GUIDE

### 3. MIXING THE SLIME

5. Pour all of the powder slowly into the test tube and avoid creating airborne dust.
6. Optional: Use a stirring tool to mix the powder into the water.
7. After the powder is mixed with the water, close the test tube with the lid and shake it for 30 seconds. Let the contents sit, shaking the tube every few minutes, until they have solidified. This takes about 15–20 minutes. After the contents have solidified, you can open up the test tube and have fun experimenting with the slime.

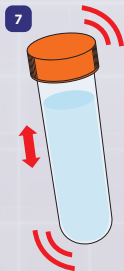
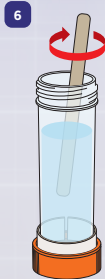

**TIP!** Depending on the amount of water, the slime may be a little firmer. Moisten your hands with water and knead it well into the slime so you can make it slimier!

## 4. CHANGING THE COLOR

8. Hold the test tube with the sunshine slime under a normal lamp and then in sunlight. In sunlight, the sunshine slime turns pink in a few seconds. This experiment shows that the slime only reacts to UV light. When the UV light

isn't shining on the slime, it will turn colorless again within a few minutes.

**Additional experiments for days with strong sunlight (in summer):** Cover the test tube with an old T-shirt, first dry and then wet. What happens?

**Disposal:** Your sunshine slime liquefies and disintegrates after 4 days. Dispose of it in a paper towel in the trash!

## WHAT'S HAPPENING?

The sunshine slime contains a substance that turns pink in the sunlight. In addition to the visible colors, the sun radiates ultraviolet (UV) light, which our eyes cannot detect. This

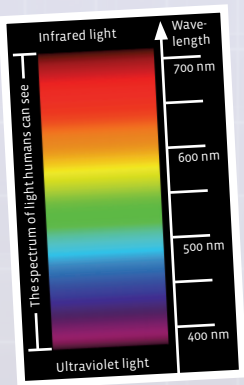

ultraviolet light has much more energy than normal visible light.

As you can see in the color spectrum (left), infrared light lies beyond red light while ultraviolet light lies beyond violet light.

Your experiments have shown that UV light is also present in the shade. In fact, you can get a sunburn in the shade, but it takes longer than in full sunshine. A thin garment also filters only part of the UV light. When wet, it lets in even more UV light!

UV light also penetrates deep into water. In fact, even half a meter of water decreases the intensity of UV light by only a quarter. Now you understand why it is so important in the summer to use waterproof sunscreen.



© 2022 Thames & Kosmos, LLC., 89 Ship St., Providence, RI, 02903 USA  
Manufacturer: © Franckh-Kosmos Verlags-GmbH & Co. KG, Pflizerstr. 5-7, 70184 Stuttgart, Germany  
+49 (0) 711 2191-0; [www.kosmos.de](http://www.kosmos.de) © Thames & Kosmos is a registered trademark of Thames  
& Kosmos, LLC. Protected by law. All rights reserved. Right to technical alterations reserved.  
Customer Service: 1-800-587-2872; [www.thamesandkosmos.com](http://www.thamesandkosmos.com)

 **THAMES & KOSMOS**

**Ooze  
Labs**



Mix Your Own

# Sunshine Slime

Make  
slime that  
changes  
color in  
sunlight!

**WARNING** — THIS  
SET CONTAINS CHEMICALS  
THAT MAY BE HARMFUL IF  
MISUSED. READ CAUTIONS  
ON INDIVIDUAL CONTAINERS  
AND IN MANUAL CAREFULLY.  
NOT TO BE USED BY  
CHILDREN EXCEPT UNDER  
ADULT SUPERVISION.

**WARNING.** Not  
suitable for children  
under 3 years.  
Choking hazard —  
small parts may be swallowed  
or inhaled. Keep the packaging  
and instructions as they  
contain important information.



Mix Your Own Slime Kits  
Ooze Labs: Sunshine Slime  
No. 575910 KIN 1619021  
Made in Taiwan

57591002D-181022



8 14743 01831 0