

© 2019 Thames & Kosmos, LLC., 301 Friendship St., Providence, RI, 02903 USA
Manufacturer: © Franckh-Kosmos Verlags-GmbH & Co. KG, Pflizerstr. 5-7, 70184 Stuttgart, Germany
+49 (0) 711 2191-0; www.kosmos.de @Thames & Kosmos is a registered trademark of Thames
& Kosmos, LLC. Protected by law. All rights reserved. Right to technical alterations reserved.
Customer Service: 1-800-587-2872; www.thamesandkosmos.com

 THAMES & KOSMOS



Super-Expanding Instant Snow

Make
fake snow
from an
incredible
super-
absorbent
polymer!

WARNING — THIS
SET CONTAINS CHEMICALS
THAT MAY BE HARMFUL IF
MISUSED. READ CAUTIONS
ON INDIVIDUAL CONTAINERS
AND IN MANUAL CAREFULLY.
NOT TO BE USED BY
CHILDREN EXCEPT UNDER
ADULT SUPERVISION.

WARNING. Not
suitable for
children under 3
years. Choking
hazard — small
parts may be
swallowed or inhaled. Keep
the packaging and instructions
as they contain important
information.



Ooze Labs: Instant Snow
No. 575008 KIN 1618078
Made in Taiwan

575008-02291018

8 14743 01399 5

INFORMATION FOR PARENTS AND ADULTS

Dear Parents,

With this kit, you will be helping your child experiment with instant snow, which is a superabsorbent polymer called sodium polyacrylate. We are asking you to read these instructions together with your child, follow them and keep them for reference. Only carry out the experiments listed in the instructions. **Do not ingest or inhale the instant snow powder:** It expands to hundreds of times its original size and can be harmful if ingested or inhaled. Do not allow the instant snow to come into contact with the eyes or mouth. Please remind your child to wash the hands thoroughly after the experiments. This set is for use only by children over 7 years. For use under adult supervision. Therefore store it out of reach of children under 7 years old and animals. This means the instant snow and the materials in the set.

Look for a good place to do the experiments. The area surrounding the experiment should be kept clear of any obstructions and away from the storage of food. Use a solid table with a top that can easily be cleaned. The working area should be cleaned up immediately after carrying out the activity. Also clean all equipment (e.g., the spatula) after use and thoroughly wash your hands. Open the instant snow packets with scissors — never with your teeth. While experimenting, please be careful not to create dust of the powder. Do not eat or drink in the experimental area and while doing the experiments. After the experiments, you can leave the instant snow to dry out for a number of days. Make sure that you put it in a place where small children or pets cannot reach it. Instant snow powder can be stored and reused. Dispose of all materials in this kit in the household trash. Do not pour the instant snow down the drain.

We hope you and your child have a lot of fun with the instant snow!

1. SETTING UP THE OOZE TUBE

CONTENTS

Test tube, lid, 3 packets of instant snow powder, wooden spatula, cardboard strip

YOU WILL ALSO NEED

Water, permanent marker, paper towel, scissors, big plastic tub

HERE'S HOW

1. Remove the contents from the test tube.
2. Use the cardboard strip to make a test tube holder by rolling it into a circular tube and fitting it into the cap. Place the test tube into the holder.

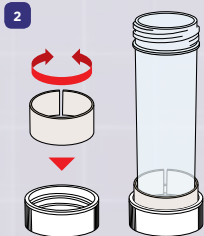
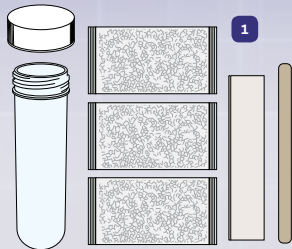

2. POWDERY SNOW

3. Use the test tube guide printed here to make three marks on the test tube with the permanent marker.

3



4. Open a packet of instant snow powder using a pair of scissors. Do not use your teeth. Be careful not to get any of the powder in your eyes or mouth.

4



5. Fill the test tube with instant snow powder up to the 13-mm line, which is approximately 5 ml.

5



80 mm
(60 ml)

42 mm
(30 ml)

13 mm
(5 ml)

TEST TUBE FILLING GUIDE

3. LET IT SNOW!

6. Add water up to the 42-mm line (about 30 ml). The powder will instantly start expanding.

Note: The snow gives off a plastic-like smell when expanding. This is normal and will dissipate.

7. Now add water up to the 80-ml line (about another 30 ml). Do you see how the snow continues to expand to absorb the water?

8. Dump the contents of the test tube into a big plastic bin. Use the wooden spatula if necessary.

9. Rinse and fill the test tube with water up to the 80-mm line. Sprinkle a small amount of snow powder into the water. Stir and observe for a few minutes. What happens?

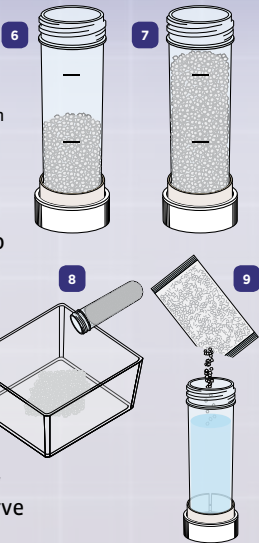

4. EXPANDING SNOW

10. Pour the contents of the test tube out onto the snow in the plastic bin.
11. Pour the rest of the snow powder from the open packet into the bin. Using the test tube, add water to the snow powder 60 ml at a time. How much water does the snow absorb?
12. Now, leave the bin uncovered for a number of days and let the water evaporate. What happens to the snow? How many days does it take for the snow to completely dry out?
13. You can use the additional snow packets for your own experiments.

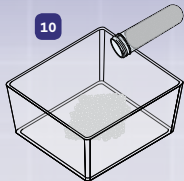

Disposal: When you are done, you can dispose of the instant snow in the household trash.

WHAT'S HAPPENING?

Instant snow powder is a material called **sodium polyacrylate**. It is a **superabsorbent polymer**. Superabsorbent means that it can absorb hundreds of times its weight in water, and expand to hundreds of times its dry size. A polymer is a material made of long chains of stretchy molecules, like plastics.

Superabsorbent polymers have a special chemical property: Inside, they have areas that strongly attract water. They are permeable, which means that water can enter them. Once inside, the water gets trapped there. The elastic polymer can expand and stretch out and to hold a lot of water.

Water can evaporate from the polymer. As the polymer dries, it shrinks again. It can be used over and over again.

Superabsorbent polymers like this are used in everyday products like baby diapers, bandages, and spill-control products.

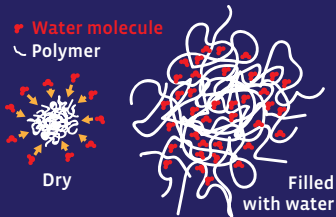

SAFETY INFORMATION

Information about the Instant Snow Powder

Instant Snow Powder:
Sodium Polyacrylate (Superabsorbent Polymer), 3 packets of 4.5-6.0 g (0.15-0.21 oz.)
Item No. 721616

Do not get in eyes, into the mouth or on clothing.
Wash hands thoroughly after handling.
Do not ingest. Do not inhale. Use only as instructed.
Keep instant snow out of reach of small children.

Use the materials carefully, as they may stick to or stain fabric, wood, carpet, or other materials. Clean with water.

First Aid Information

If any instant snow gets into the eyes: Wash out eye with plenty of water, holding eye open, if necessary. Seek immediate medical advice.
If swallowed: Wash out mouth with water, drink some fresh water. Do not induce vomiting. Seek immediate medical advice.
In case of doubt, seek medical advice without delay. Take the instant snow and its packet / this manual with you.

1ST EDITION 2019
© 2019 THAMES & KOSMOS, LLC, 301 FRIENDSHIP ST.,
PROVIDENCE, RI, 02903, USA
1-800-587-2872 WWW.THAMESANDKOSMOS.COM
© 2019 FRANCKH-KOSMOS VERLAGS-GMBH & CO. KG,
PFIZERSTR. 5-7, 70184 STUTTGART, GERMANY
+49 (0) 711 2191-0 WWW.KOSMOS.DE
® THAMES & KOSMOS IS A REGISTERED TRADEMARK OF
THAMES & KOSMOS, LLC.
PROTECTED BY LAW. ALL RIGHTS RESERVED. WE RESERVE
THE RIGHT TO MAKE TECHNICAL CHANGES.

ILLUSTRATIONS/PHOTOS: THAMES & KOSMOS, LLC;

THIS WORK, INCLUDING ALL ITS PARTS, IS COPYRIGHT PROTECTED. ANY USE OUTSIDE THE SPECIFIC LIMITS OF THE COPYRIGHT LAW WITHOUT THE CONSENT OF THE PUBLISHER IS PROHIBITED AND PUNISHABLE BY LAW. THIS APPLIES SPECIFICALLY TO REPRODUCTIONS, TRANSLATIONS, MICROFILMING, AND STORAGE AND PROCESSING IN ELECTRONIC SYSTEMS AND NETWORKS. WE DO NOT GUARANTEE THAT ALL MATERIAL IN THIS WORK IS FREE FROM COPYRIGHT OR OTHER PROTECTION.

PRINTED IN TAIWAN