

GECKO RUN

MARBLE RUN FLEX-CORNER



© 2024 Franckh-Kosmos Verlags-GmbH & Co. KG • Pfizerstrasse 5-7 • 70184 Stuttgart, DE

This work, including all its parts, is copyright protected. Any use outside the specific limits of the copyright law is prohibited and punishable by law without the consent of the publisher. This applies specifically to reproductions, translations, microfilming, and storage and processing in electronic systems and networks. We do not guarantee that all material in this work is free from other copyright or other protection.

Concept: Richard Schmising

Editorial: Richard Schmising

Technical product development: Deryl Tjahja

Product design: Manuel Aydt, aydt design, Pforzheim

Design concept for instructions: Atelier Bea Klenk, Berlin

Layout of packaging and instructions: Michael Schlegel, Würzburg

English manual editing: Ava Tessitore, Hannah Mintz

3D illustrations for instructions and packaging: Andreas Resch

Design concept & packaging design: Peter Schmidt Group, Hamburg

Additional graphics and layout: Dan Freitas

1st Edition © 2024 Thames & Kosmos, LLC, Providence, RI, USA

Thames & Kosmos® is a registered trademark of Thames & Kosmos, LLC.

Distributed in North America by Thames & Kosmos, LLC. Providence, RI 02903

Phone: 800-587-2872;

Web: www.thamesandkosmos.com

Distributed in United Kingdom by Thames & Kosmos UK LP, Cranbrook, Kent TN17 3HE

Phone: 01580 713000;

Web: www.thamesandkosmos.co.uk

We reserve the right to make technical changes.

Printed in Germany/Imprimé en Allemagne

Do you have any questions?

Our tech support team would be glad to help you!

Thames & Kosmos US
Email: support@thamesandkosmos.com
Phone: 1-800-587-2872

Thames & Kosmos UK
Web: thamesandkosmos.co.uk
Phone: 01580 713000



KIT CONTENTS

What's in your expansion pack:

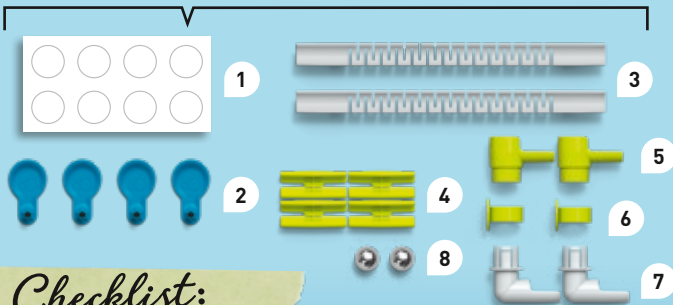

Checklist:

✓	No.	Description	Quantity	Part No.
○	1	Sheet with nano-adhesive pads	1	726192
○	2	Adapter	4	726603
○	3	Track	2	726605
○	4	Track bridge	4	726606
○	5	Flex-corner, entrance	2	728309
○	6	Flex-corner, ring adapter	2	728310
○	7	Flex-corner, exit	2	728311
○	8	Metal marble	2	726604

Good to know!

You can reorder extra nano-adhesive pads and metal marbles from our website.



You will also need a Gecko Run Starter Set or Deluxe Starter Set. Its instructions contain all the information about the components and the instructions for safe handling of the Gecko Run parts.



WARNING!

Not suitable for children under 3 years. Choking hazard — small parts and small balls may be swallowed or inhaled. Keep the packaging and instructions as they contain important information.

YOUR NEW TRICK

Flex-Corner

The flex-corner makes your Gecko Run even more versatile. Whether you need to navigate around corners or avoid obstacles, your flex-corner makes it possible. To get started, click the three parts together and stick a nano-adhesive pad to the ring adapter.

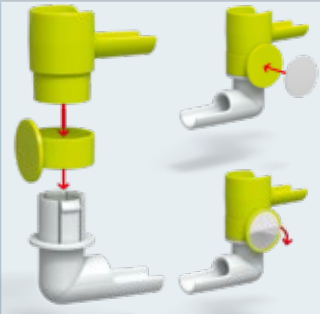

TIPS AND TRICKS

Get to know the first function of your flex-corner: Whether your playing surface is a closet, a refrigerator, or something completely different: It's finally easy to go around corners.

If you want to turn around a projecting corner, take your flex-corner apart and reassemble it without the ring adapter. The flex-corner will be held in place by the track adapters and bridges.

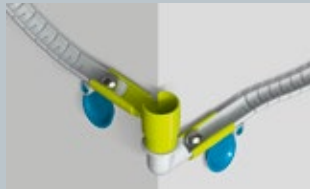

IT'S BEST TO USE THE FLEX-CORNER WITH TWO TRACK BRIDGES. YOU WILL FIND FOUR OF THEM IN THIS EXPANSION.

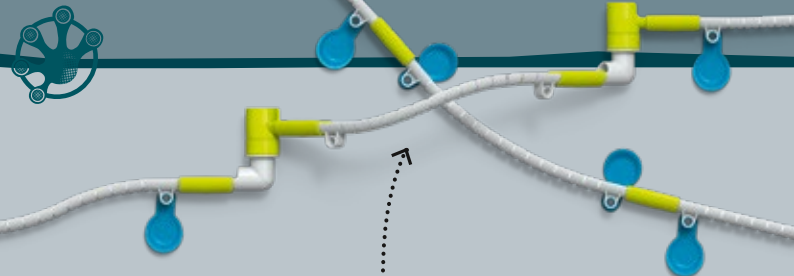

But that's not all your flex-corner can do! If you connect two flex-corners using a track and track bridges, you can circumvent an obstacle — whether it's a window frame or another Gecko Run track.

You can also use two flex-corners, connected using tracks and track bridges, to connect two separate playing surfaces — no matter what angle you have to turn.

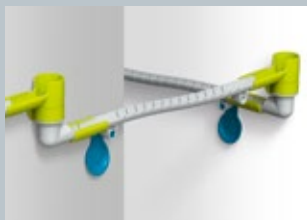

TIP

YOUR FLEX-CORNER IS ALSO THE PERFECT TOOL TO MOVE YOUR MARBLE AWAY FROM THE PLAYING SURFACE AND INTO THE ROOM — FOR INSTANCE, TO DIRECT IT INTO A SEPARATE MARBLE RUN YOU DESIGNED.

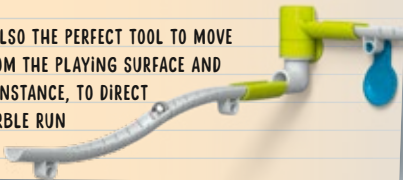

Now it's up to you to discover the possibilities of your flex-corner!