

**GECKO**

**RUN**

**MARBLE RUN  
LOOP**

THAMES & KOSMOS



*Loop the  
Loop!*



## KIT CONTENTS

What's in your expansion pack:

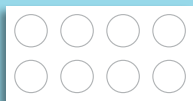

1

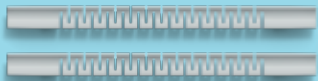

3



2



4



5

6



7

## Checklist:

✓	No.	Description	Quantity	Part No.
<input type="radio"/>	1	Sheet with nano-adhesive pads	1	726192
<input type="radio"/>	2	Adapter	4	726603
<input type="radio"/>	3	Track	2	726605
<input type="radio"/>	4	Track bridge	2	726606
<input type="radio"/>	5	Loop top	1	726660
<input type="radio"/>	6	Loop bottom	1	726647
<input type="radio"/>	7	Metal marble	2	726604

*Good to know!*

You can reorder extra nano-adhesive pads and metal marbles from our website.



You will also need a Gecko Run Starter Set. Its instructions contain all the information about the components and the instructions for safe handling of the Gecko Run parts.



## WARNING!

Not suitable for children under 3 years. Choking hazard — small parts and small balls may be swallowed or inhaled. Keep the packaging and instructions as they contain important information.

## YOUR NEW TRICK

### Loop

The loop adds even more action to your Gecko Run marble run. Connect the top and bottom loop parts as shown and stick a nano-adhesive pad to the back of the loop. Then remove the thin foil from the nano-adhesive side.

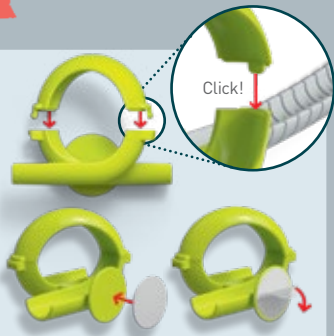

### Track bridge

The left side of the loop must be connected to a track using a track bridge.



## TIPS AND TRICKS

Build a test track to get a feel for the loop's properties and find out how much momentum your marble needs to make it all the way around. Because it is a small distance away from the playing surface, no adapter can be connected to the rightmost hole of the track on the left.

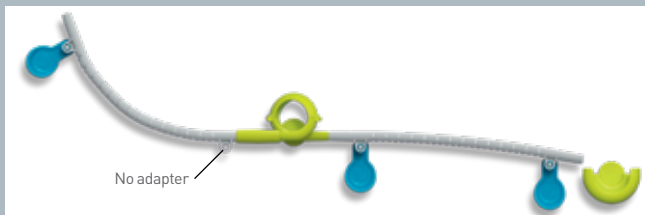



## ★ TIP

**THE RIGHT EXIT OF THE LOOP DOES NOT HAVE TO BE CONNECTED TO THE TRACK VIA A TRACK BRIDGE. HOWEVER, ADDING A TRACK BRIDGE ENSURES THAT THE MARBLE LOSES LESS MOMENTUM.**

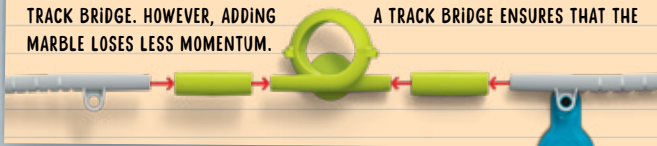

© 2023 Franckh-Kosmos Verlags-GmbH & Co. KG • Pfizerstrasse 5-7 • 70184 Stuttgart, DE  
This work, including all its parts, is copyright protected. Any use outside the specific limits of the copyright law is prohibited and punishable by law without the consent of the publisher. This applies specifically to reproductions, translations, microfilming, and storage and processing in electronic systems and networks. We do not guarantee that all material in this work is free from other copyright or other protection.

Concept: Richard Schmising

Editorial: Richard Schmising

Technical product development: Deryl Tjahja

Product design: Manuel Aydt, aytdesign, Pforzheim

Design concept for instructions: Atelier Bea Klenk, Berlin

Layout of packaging and instructions: Michael Schlegel, Würzburg

English manual editing: Hannah Mintz, Ted McGuire

3D illustrations for instructions and packaging: Andreas Resch

Design concept & packaging design: Peter Schmidt Group, Hamburg

Additional graphics and layout: Dan Freitas

1st Edition © 2023 Thames & Kosmos, LLC, Providence, RI, USA

Thames & Kosmos® is a registered trademark of Thames & Kosmos, LLC.

Distributed in North America by Thames & Kosmos, LLC, Providence, RI 02903

Phone: 800-587-2872; Web: [www.thamesandkosmos.com](http://www.thamesandkosmos.com)

Distributed in United Kingdom by Thames & Kosmos UK LP, Cranbrook, Kent TN17 3HE

Phone: 01580 713000; Web: [www.thamesandkosmos.co.uk](http://www.thamesandkosmos.co.uk)

We reserve the right to make technical changes.

Printed in Germany/Imprimé en Allemagne

### Do you have any questions?

Our customer service team would be glad to help you!

Thames & Kosmos US  
Email: [support@thamesandkosmos.com](mailto:support@thamesandkosmos.com)  
Phone: 1-800-587-2872

Thames & Kosmos UK  
Web: [thamesandkosmos.co.uk](http://thamesandkosmos.co.uk)  
Phone: 01580 713000